

# F G E M I N I

## REDEFINING MANUFACTURING

---

With our team of skilled artisans and a 50,000 sq ft full-service facility, we create well-engineered products with an unwavering commitment to quality. Using our decades of experience, a deep stock of inventory, and with collaboration key, we **celebrate thoughtful design** through every product we make.

## WHAT CAN WE BUILD FOR YOU?

---

# MARKETS SERVED

E-Commerce

Design Trade

Corporate

Galleries & Museums

Health Care

Hospitality & Events

4

## ENVIRONMENTS

Wall Coverings & Windows

Signage & Wayfinding

Visual Merchandising

Gallery Walls

Art Sourcing & Curation

16

## FRAMING

Custom Framing

Ecommerce Fulfillment

Mirrors

24

## ACRYLIC FABRICATION

Sandwich Frames

Acrylic Décor

Acrylic Cases & Vitrines

32

## WOOD FABRICATION

Custom Millwork

36

## MORE CAPABILITIES

Packaging

Roll & Flatbed Printing

42

## FINAL MILE

Packing, Shipping, Crating

Delivery & Installation





# ENVIRONMENTS



*Transform your space* with designs that are expertly crafted to elevate every environment. From custom wall coverings and signage, to curated gallery walls and visual merchandising, our designs blend artistry and functionality to make your concept a reality.

---





# WALL COVERINGS & WINDOWS









# SIGNAGE & WAYFINDING









# VISUAL MERCHANDISING









# GALLERY WALLS

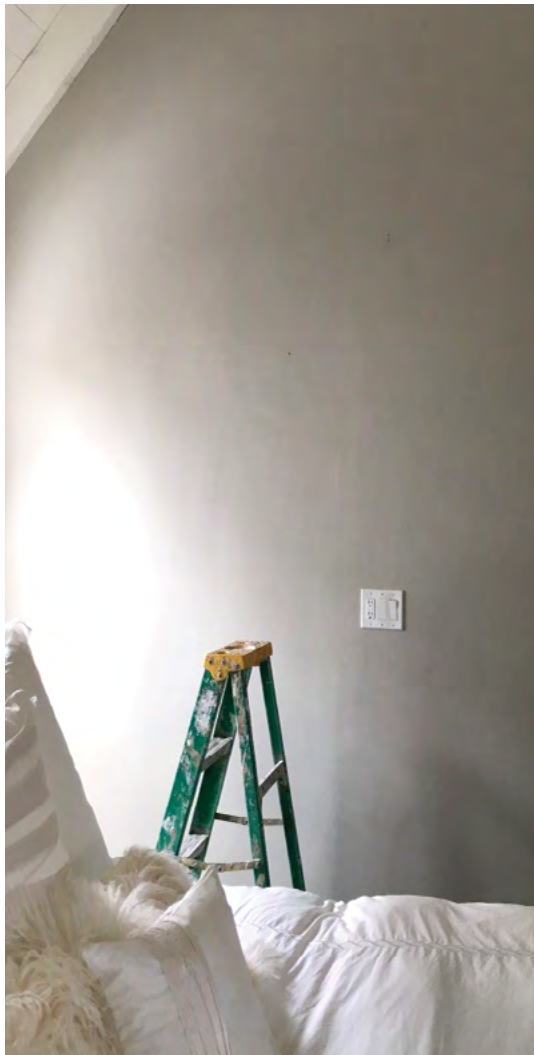
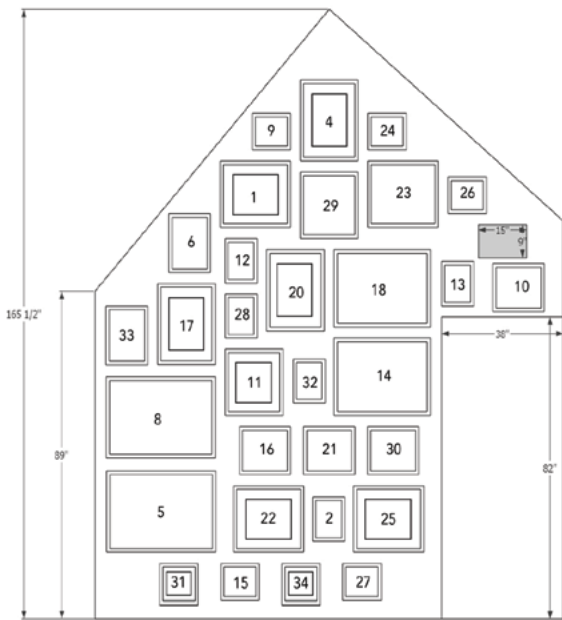







# ART SOURCING & CURATION









The background of the entire page is a dark, monochromatic photograph of a wall covered with numerous framed black and white photographs. The frames are arranged in a grid-like pattern, though some are slightly offset. The photographs themselves depict various industrial and manufacturing environments. One prominent photo in the upper left shows a worker in a dark shirt and light pants standing in a large, open industrial space with high ceilings and structural beams. Another photo to its right shows a close-up of a person wearing a hard hat and safety gear, possibly operating machinery. Below the main title, another photo shows a complex industrial machine with multiple rollers and a conveyor system. The overall aesthetic is industrial and professional.

# FRAMING



*Elevate your art* with thousands of custom options for all your unique and large-scale picture framing needs. And with our seamless high-volume Ecommerce fulfillment plus deep in-stock inventory, we can provide quality solutions for your business - fast.

---





# CUSTOM FRAMING









# ECOMMERCE FULFILLMENT









# MIRRORS











# ACRYLIC FABRICATION

---



*Showcase your style* with precision-crafted sandwich frames, acrylic décor, and museum-quality vitrines & displays. As industry leaders in acrylic fabrication, we blend innovative techniques with exceptional quality for each and every custom acrylic project.

---





# SANDWICH FRAMES









# ACRYLIC DÉCOR









# ACRYLIC CASES & VITRINES









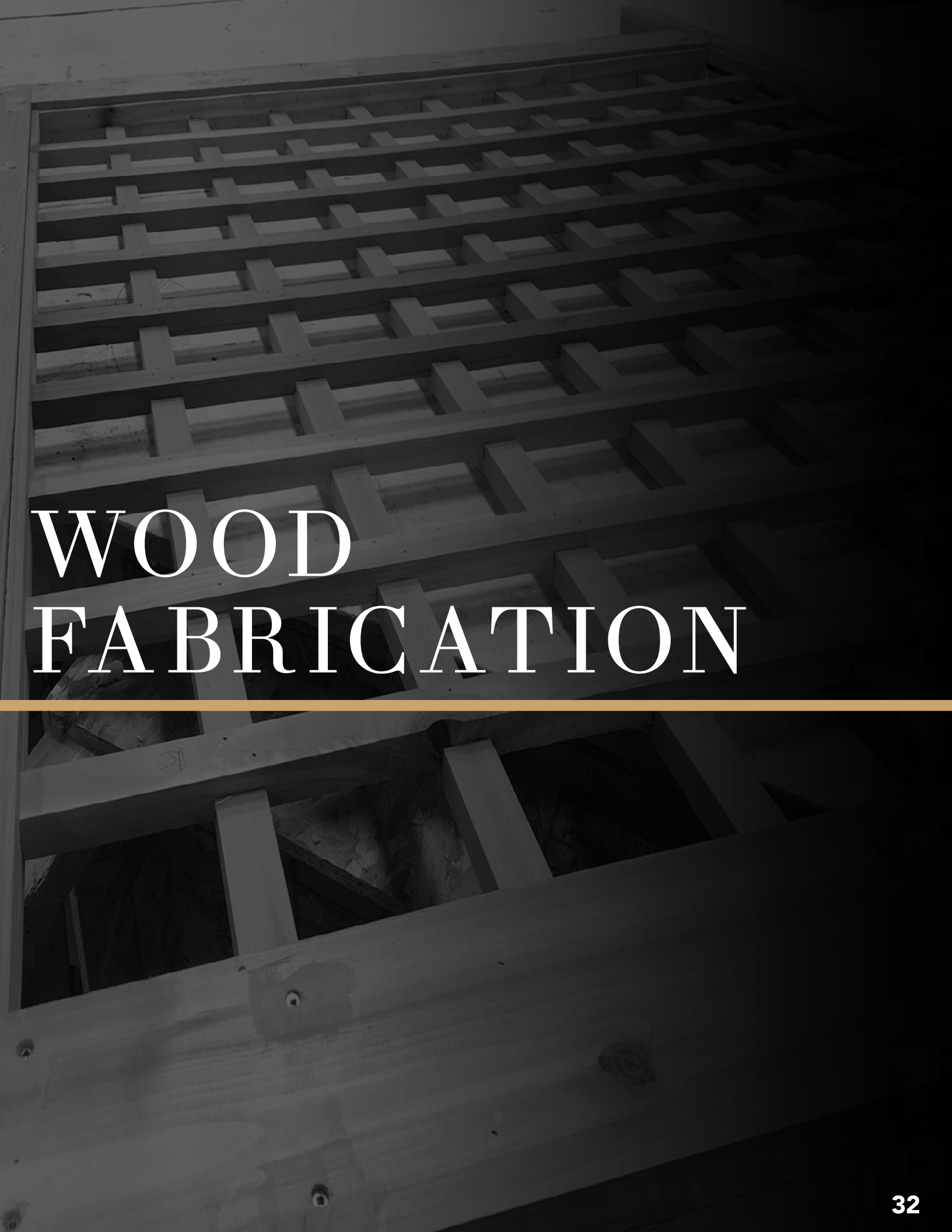

# WOOD FABRICATION



*Build your vision* to meet only the highest standards of quality and wood craftsmanship. From functional elements like doors and locks, to unique details and decorative finishes - we can help you to create pieces that seamlessly blend style and purpose.

---





# CUSTOM MILLWORK

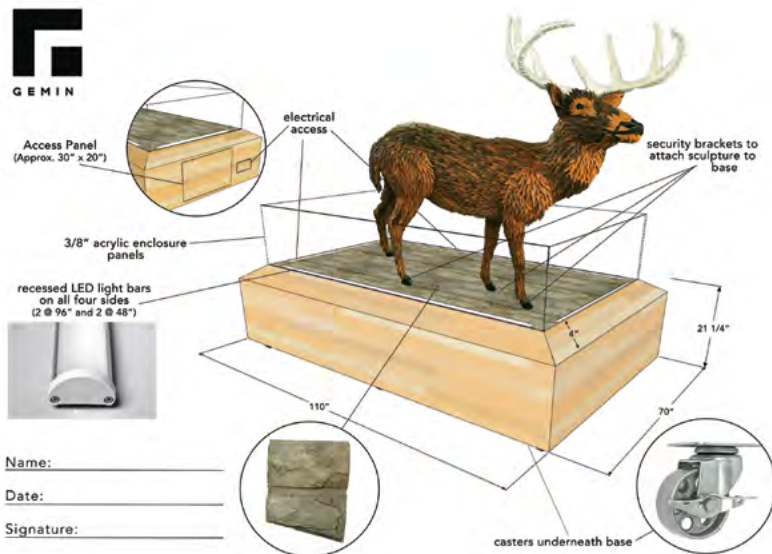



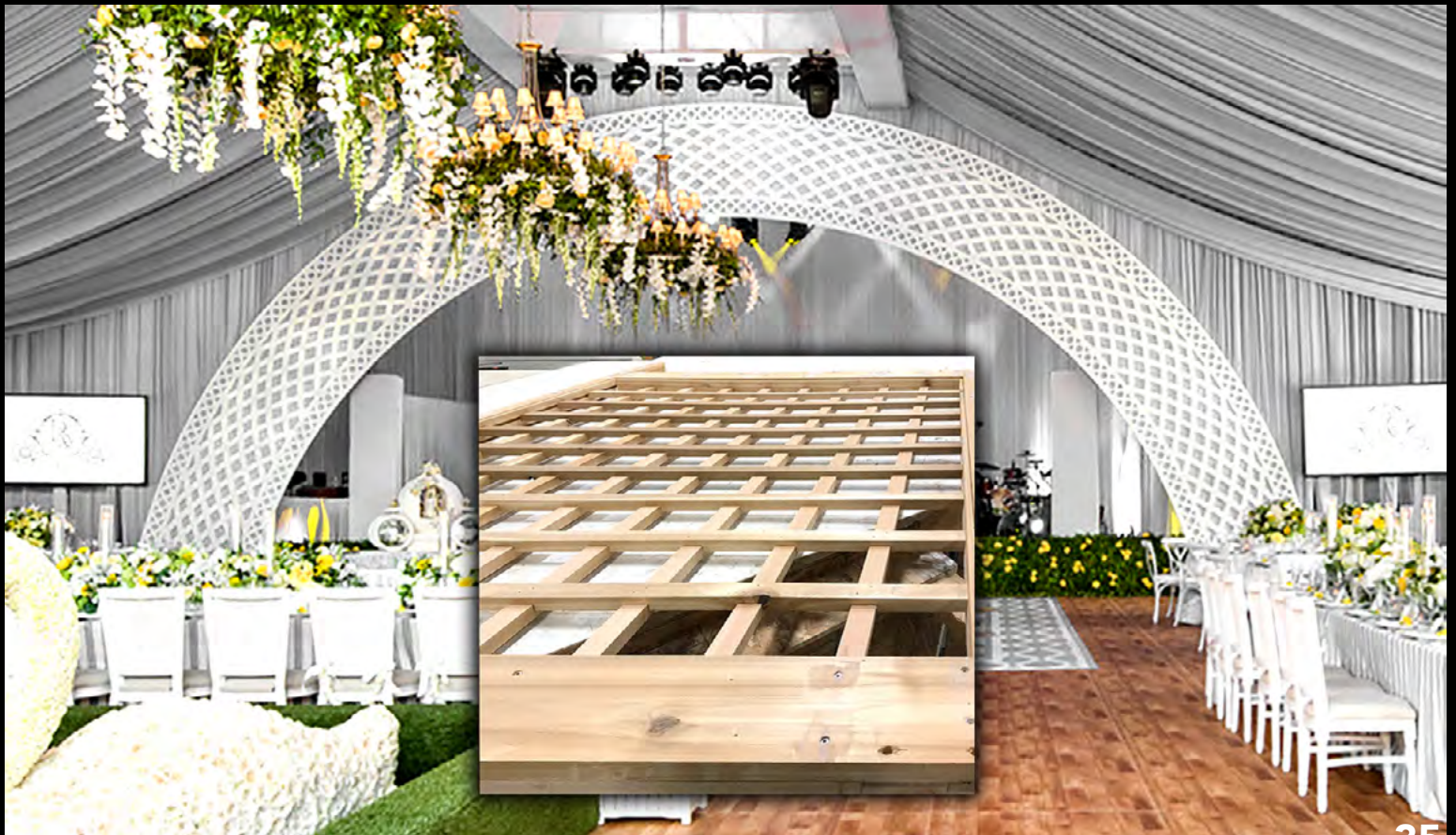





# MORE CAPABILITIES

---



*Ideate your design* alongside our in-house creative team and let us bring it to life! From concept to completion, we provide expertise at each step of the process, providing you with personalized service and custom solutions no matter what your next project is.

---

- History Walls
- Corporate Gifts & Recognition
- Etched Business Cards
- Acrylic Brackets
- Pedestals
- Laser Cutting & Engraving
- Digital Photo Restoration
- Custom Décor



# PACKAGING

A collection of various retail packaging items displayed against a black background. The items include:

- A white shopping bag with a gold logo reading "B · A · D ·" and the website "www.briggsaustindoherty.com".
- A bright green shopping bag.
- A white shopping bag with a green braided handle and the text "BOTTEGA VENETA".
- A light blue rectangular box.
- A small white shopping bag with the text "STEEL AMERICAN LUXURY".
- A stack of three hexagonal boxes with orange and pink stripes.
- A stack of three hexagonal boxes with orange and pink stripes, some open.
- A grey drawstring pouch with the text "CAREX" lying on a green fabric surface.
- Two pieces of cream-colored tissue paper with the text "ABLE FASHIONABLE LOCAL + GLOBAL".

38







# ROLL & FLATBED PRINTING











# FINAL MILE



*White glove service* ensures your pieces are handled with the utmost care, from thoughtful packaging/crating and secure shipping to flawless delivery. Our expert installation team manages art of all sizes, prioritizing safety and precision for flawless placement.

---





# PACKING, SHIPPING, CRATING









# DELIVERY & INSTALLATION









# GEMINI



For more information visit:  
[geminibuildsit.com](http://geminibuildsit.com) | [showcaseacrylics.com](http://showcaseacrylics.com)



(800) 323-3575 | [solutions@geminibuildsit.com](mailto:solutions@geminibuildsit.com)  
2755 Spectrum Dr | Elgin, IL 60124